

MD016016

齿轮箱规格 Gearbox Specifications

外径 Outer diameter	16mm	轴承 Bearing	含油轴承 Porous bearing	滚动轴承 Rolling bearing
材质 Material	五金 Metal	轴向窜动 Axial endplay	≤0.3mm	≤0.3mm
旋转方向 Direction of rotation	cw & ccw	输出轴径向负载 Radial loading on output shaft	≤20N	≤30N
齿轮箱回程差 Gear backlash	≤2°	工作温度 Operating temperature range	-30 ~ +100°C	

齿轮级数 Gearbox Stages

		1	2	3	4
减速比 Reduction ratio		4 / 6	16 / 24 / 36	64 / 96 / 144 / 216	256 / 384 / 576 / 864 / 1296
最大容许扭力 (gf.cm) Max rated torque of gearbox (gf.cm)		5000	5000	5000	5000
瞬间容许力矩 (gf.cm) Instant torque of gearbox (gf.cm)		10000	10000	10000	10000
齿轮箱效率 (%) Gearbox efficiency (%)		90	85	80	75
长度 (mm) Gearbox length L1 (mm)		11.5	14.8	18.1	21.4

技术插图 | Technical Drawing

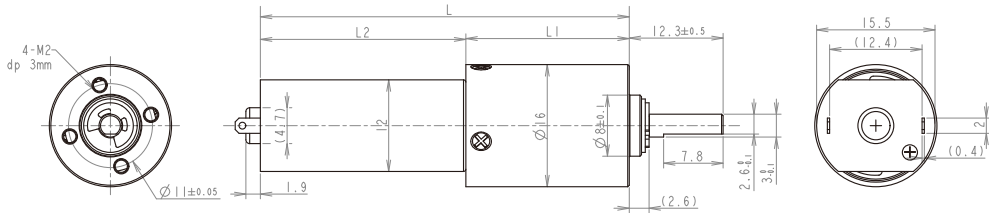

马达规格参数 Motor Specifications

马达(可选择) Motor type (optional)	直流有刷电机、直流无刷电机、空心杯电机、步进电机 Brushed DC motor, Brushless DC motor, Coreless motor, Stepper motor	输入速度 Input speed	≤15000rpm
电压(可选择) Voltage (optional)	3-24V	负载电流 Current	300mA max

参考数据 (马达定义值: 6V 8000rpm) 下表根据马达定义值测试, 数据只作为参考值。 Parameter (values at 6V & 8000rpm) The following data is for reference only.

型号 Model	Rated Speed 额定转速	Max Speed 最高转速	Max Rated Torque 额定容许力矩	Max Instant Torque 瞬间容许力矩	Reduction Ratio 减速比	Gearbox Length 减速箱长 L1	Overall Length 总长 L
	rpm	rpm	gf.cm	gf.cm		mm	mm
MD016016-4	1875	7500	5000	10000	4	11.5	38.4
MD016016-6	1250	5000	5000	10000	6		
MD016016-16	469	1875	5000	10000	16	14.8	41.7
MD016016-24	313	1250	5000	10000	24		
MD016016-36	208	833	5000	10000	36		
MD016016-64	117	469	5000	10000	64	18.1	45.0
MD016016-96	78	313	5000	10000	96		
MD016016-144	52	208	5000	10000	144		
MD016016-216	35	139	5000	10000	216		
MD016016-256	29	117	5000	10000	256	21.4	48.3
MD016016-384	20	78	5000	10000	384		
MD016016-576	13	52	5000	10000	576		
MD016016-864	9	35	5000	10000	864		
MD016016-1296	6	23	5000	10000	1296		

注: 可根据客户要求定制 Please contact us for customized products